

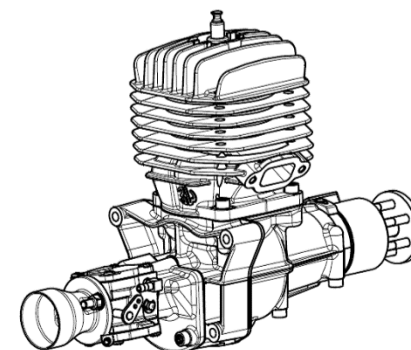

## **Annex A**

### **3W-80Xi**

# 1. 3-view drawing

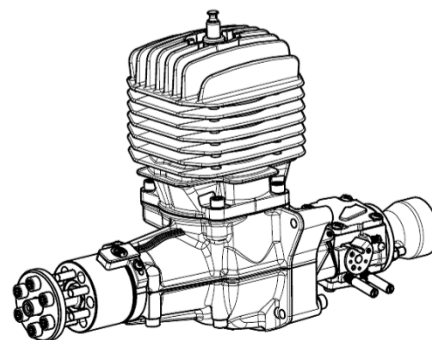
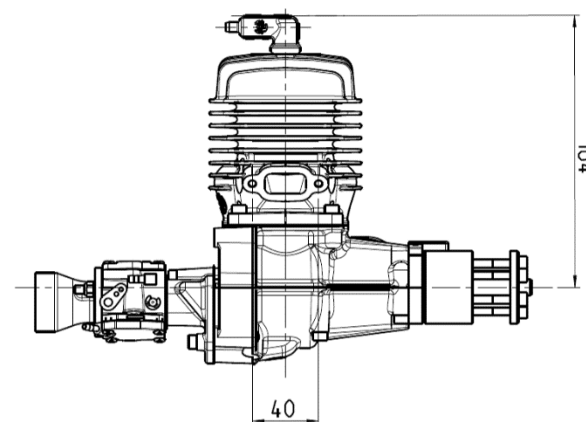
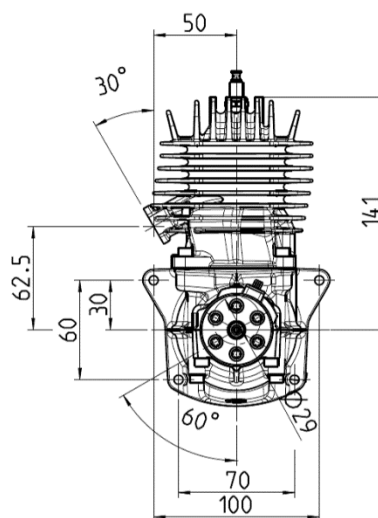
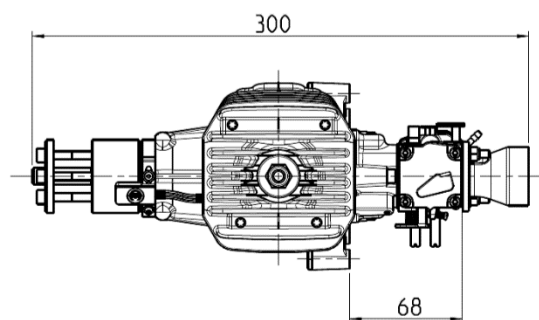
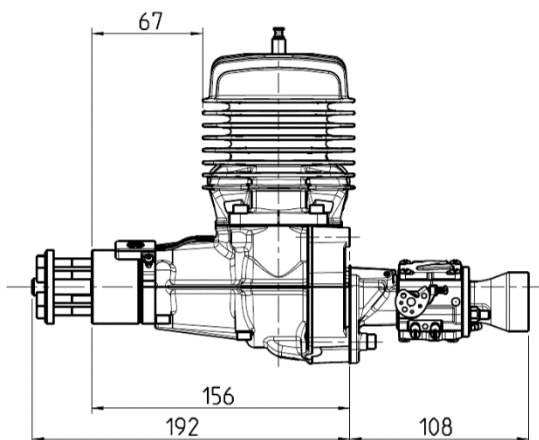
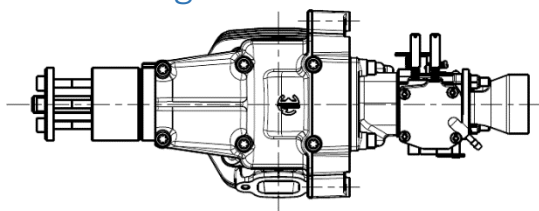

## 2. Drilling template

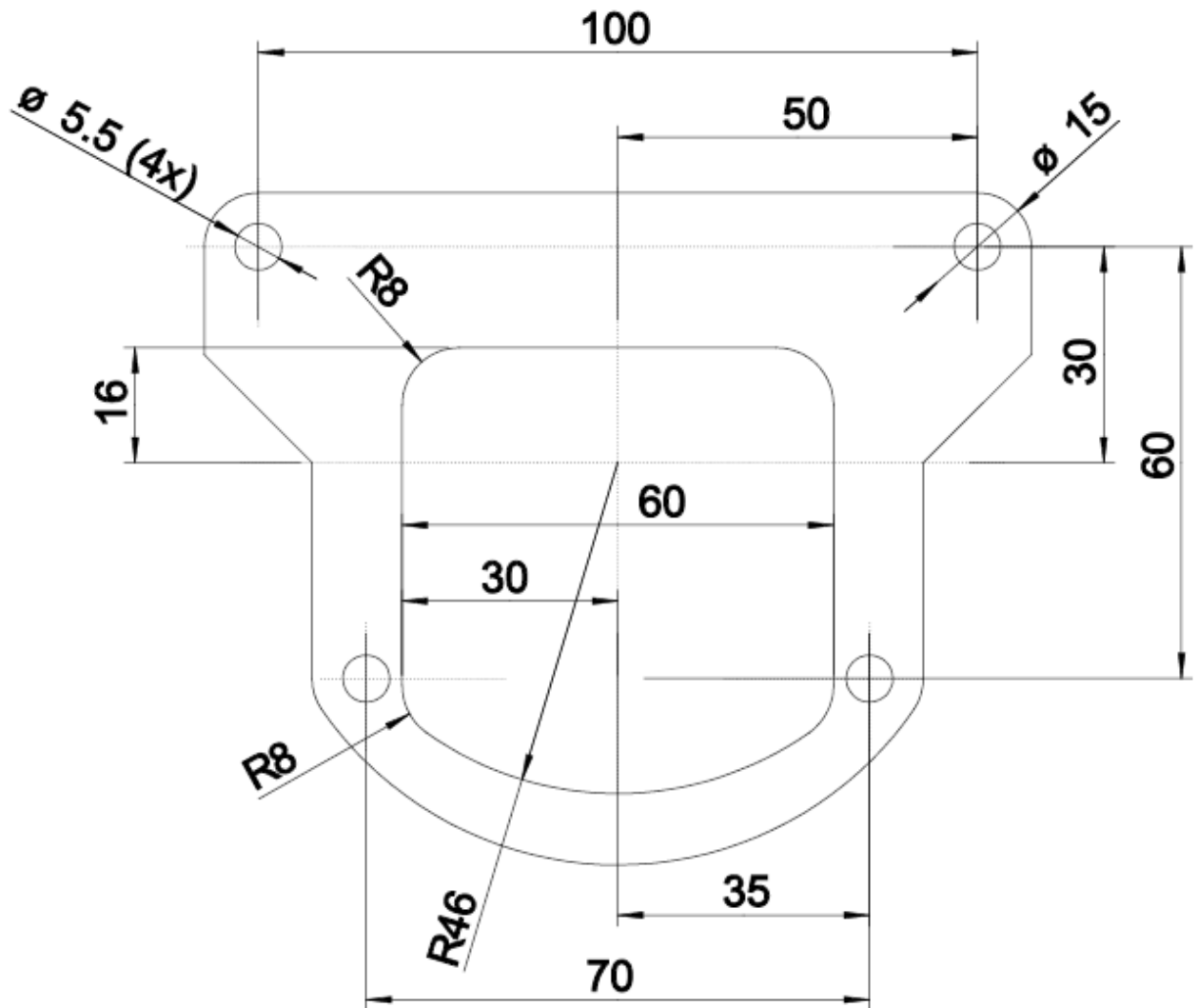



### 3. Specifications

	3W-80Xi
Cylinder capacity	78.00 ccm
Power	8.5 HP (6.2 KW)
Bore diameter	50.00 mm
Stroke	40.00 mm
Speed range	1,300 – 8,500 rpm
Weight, incl. ignition	2,375 g
Crankshaft	3 ball bearing
Rods	Needle bearings at both ends
Oil / gasoline ratio	1 : 50 – 1: 80 (min. 92 Octan)
IIS – ignition	6.0 – 8.4 V, 5 cells or 2 cells LiPo
2-blade propeller	24 x 12 wood part number 10.101.553 26 x 10 wood part number 10.101.561 26 x 12 wood part number 10.101.565 27 x 10 wood part number 10.101.573 27 x 12 wood part number 10.101.577